



Specifications

Bathroom Solutions
(31" & 33 3/4" Tall) and Accessories

Physical room characteristics & space limitations in bathrooms vary. These specs are for planning purposes; If you need additional information not listed here please contact customer service via our website.

Measurement	Base Vanities (2 Doors)				Drawer Banks (4 drawers)					Suspended Drawer Unit (SDU)	
	21 x 21	24 x 21	27 x 21	30 x 21	12 x 21	15 x 21	18 x 21	21 x 21	24 x 21	24 x 21	30 x 21
A	21	24	27	30	12	15	18	21	24	24	30
B	21									21	21
C	31									6 3/4	6 3/4
D	18 1/2									-	-
E	5									-	-
F	2 5/8									-	-
G	26									-	-
H	5 3/4									-	-
I	22 1/4									-	-
J	20	23	26	29	11	14	17	20	23	-	-
K	-	-	-	-	10 3/4	13 3/4	16 3/4	19 3/4	22 3/4	-	-

For TALL 33 3/4 vanities, refer to the following dimensions:

C = 33 3/4 G = 28 3/4 I = 25

C = 8

KEY (in inches):

- A = Overall Vanity Width (left to right)
- B = Overall Vanity Depth (front to back)
- C = Overall Vanity Height (top to bottom)
- D = Footprint Depth (back to toe kick)
- E = Toe-Kick Height
- F = Toe-Kick Inset (depth)
- G = Face Frame Height (cabinet height minus the toe kick)
- H = Floor to Bottom Deck Shelf
- I = Vertical height Clearance in back of cabinet (bottom deck shelf to back brace)
- J = Horizontal Width Clearance (between side panels)
- K = Drawer System Width (boxes, slides, and supports)

NOTE: WHITE CABINET REVEALS White *drawer banks* have a 1/2" face frame reveal to allow for adjacent cabinet drawer/door openings. All Bathroom Solutions two door vanities and other standard white vanities will have a 1/8" face frame reveal (nearly flush with cabinet sides).

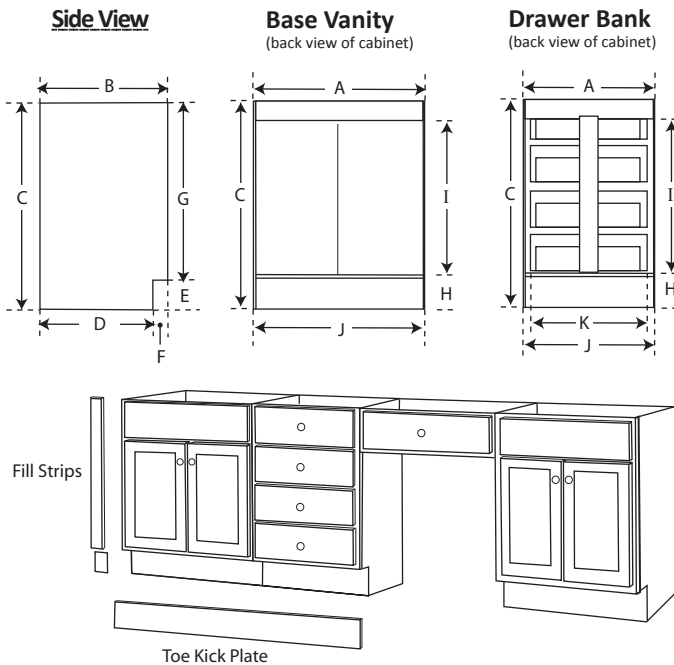

Suspended Drawer Unit

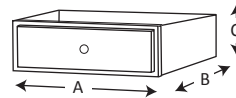

Bathroom Solutions is a modular cabinet program offering a wide selection of sink base vanities, drawer banks, suspended drawer units, linen cabinets and more. Accessory items like fill strips and toe kick plates put the finishing touches to those wall to wall applications or unusual bath-room configurations. Don't settle for close enough, design your bathroom exactly the way you want it with Bathroom Solutions.

Accessories

Item	Length (inches)	End Profiles (Width x depth)
Toe Kick Plate (TKP)	84"	5" 1/2
Fill Strips (2 pieces: Cabinet & Toe Kick Sections)	31" & 33 3/4"	6" 3/4
	31", 33 3/4" & 78"	3" 3/4
Base Board	84"	2" 3/4
Trim Strips	31", 33 3/4" & 78"	1 3/8" 3/8

See SPEC pages 7-8 for related product
See INFO-2 for installation suggestions